



MALI
VILLAS

WHERE HEARTFELT DREAMS
MEET ARCHITECTURAL BRILLIANCE



ABOUT US & SUCCESS STORY



With over 30 years of tourism expertise, C & N Bungalow Patong Co., Ltd. offers exceptional accommodations. Explore our three hotel branches in Phuket and Phang Nga, where comfort and top - tier hospitality await.

C&N Hotel

in the heart of Patong, offers 111 elegant rooms and is your gateway to local excitement.

C&N Resort and Spa

offers 45 luxurious hillside rooms near Patong's Pearl Circle, blending privacy, wellness, and relaxation.

C&N Koh Kho Khao Beach Resort

Resort in Phang Nga offers 39 serene seaside rooms, ideal for a peaceful, nature - filled escape.



At **C & N Koh Kho Khao Beach**, guests frequently stay 30 days or longer, leading us to create exclusive pool villas. We began by constructing two pool villas on Koh Kho Khao. Due to the positive response, we're expanding our offerings, driven by strong demand for luxurious accommodations.



With extensive project experience, we are excited to expand into real estate by establishing Maliwan Asset Co., Ltd. We're committed to creating high - quality residences focused on the environment and convenience. Our first project Mali Villas Thalang, will be constructed by SC Electric Co., Ltd. under our supervision with the concept of

“ WHERE HEARTFELT DREAMS
MEET ARCHITECTURAL BRILLIANCE ”



Discover the magic of
PHUKET :

**YOUR ULTIMATE DESTINATION
FOR LUXURY LIVING**

Imagine a tropical paradise where every day feels like a serene escape - welcome to Phuket, Thailand's premier island. Here, stunning beaches with crystal - clear waters, vibrant culture, and modern luxury blend seamlessly. Phuket offers more than just homes; it provides a lifestyle rich in cultural experiences, from bustling markets to exquisite dining and lively nightlife.







STORY *of* MALI VILLAS

Mali Villas, inspired by our mother's dream of a perfect home, is crafted with quality in a nurturing environment that fosters community bonds. Every detail embodies her vision, creating a serene haven.





IN THAI
Jasmine
IS KNOWN AS
MALI

“**Mali**” symbolizes pure love and sincere intentions, fostering relaxation and serenity. Each villa in our community is a sanctuary where families can cherish quality time and experience genuine warmth and thoughtfulness.



A COLLECTION of **7** EXQUISITELY DESIGNED VILLAS

Each villa embodies modern luxury, designed for a fulfilling living experience. Sunlit and airy interiors invite all generations to connect. Fresh air and underground systems provide comfort without AC, while solar roofs boost energy efficiency and reduce reliance on traditional electricity sources.

Our mission is to craft homes that seamlessly blend luxurious living with sustainability, fostering a warm and vibrant community.





Project Information

Project Name : Mali Villas
Developer : Maliwan Asset
Project Location : Thalang District, Phuket
Project Land Size : 2-3-36 Rai
Land Size : 99-127 Sq.w.
Usable Area : 315-345 Sq.m.

Product : 3 Bedrooms Villa

- A1 Maliwan
- A2 Malichat
- A3 Malilaung
- A4 Malison
- A5 Malila
- A6 Maluli
- A7 Phutthachat

Total : 7 units

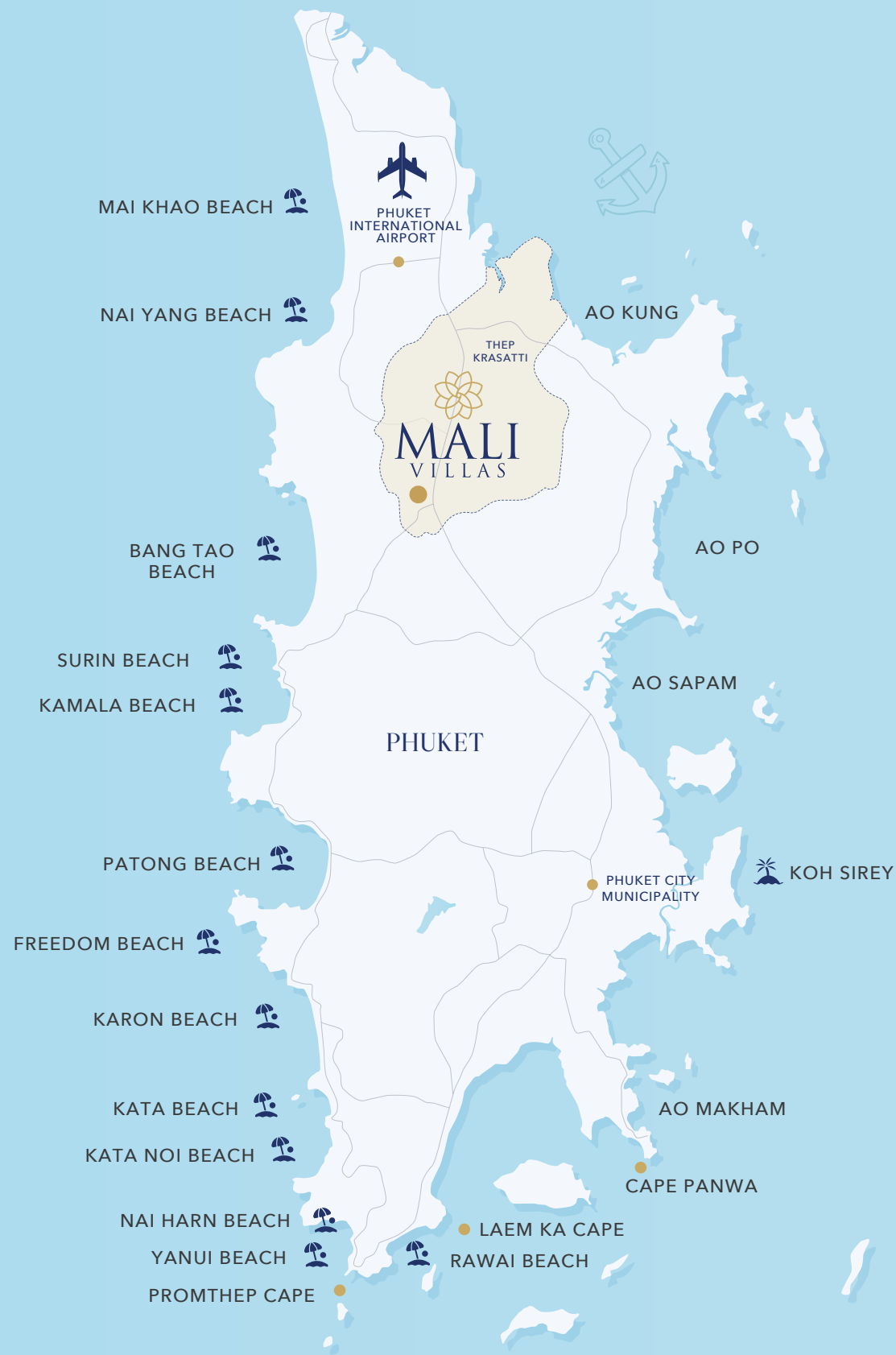

Project *Location*

Our project is ideally located just 1.5 kilometers from Baan Kian fresh market and 5 - 15 minutes from Layan Beach. Nestled in a central hub with vibrant neighborhoods and easy travel options, our villas offer unmatched convenience for a luxurious and connected lifestyle.

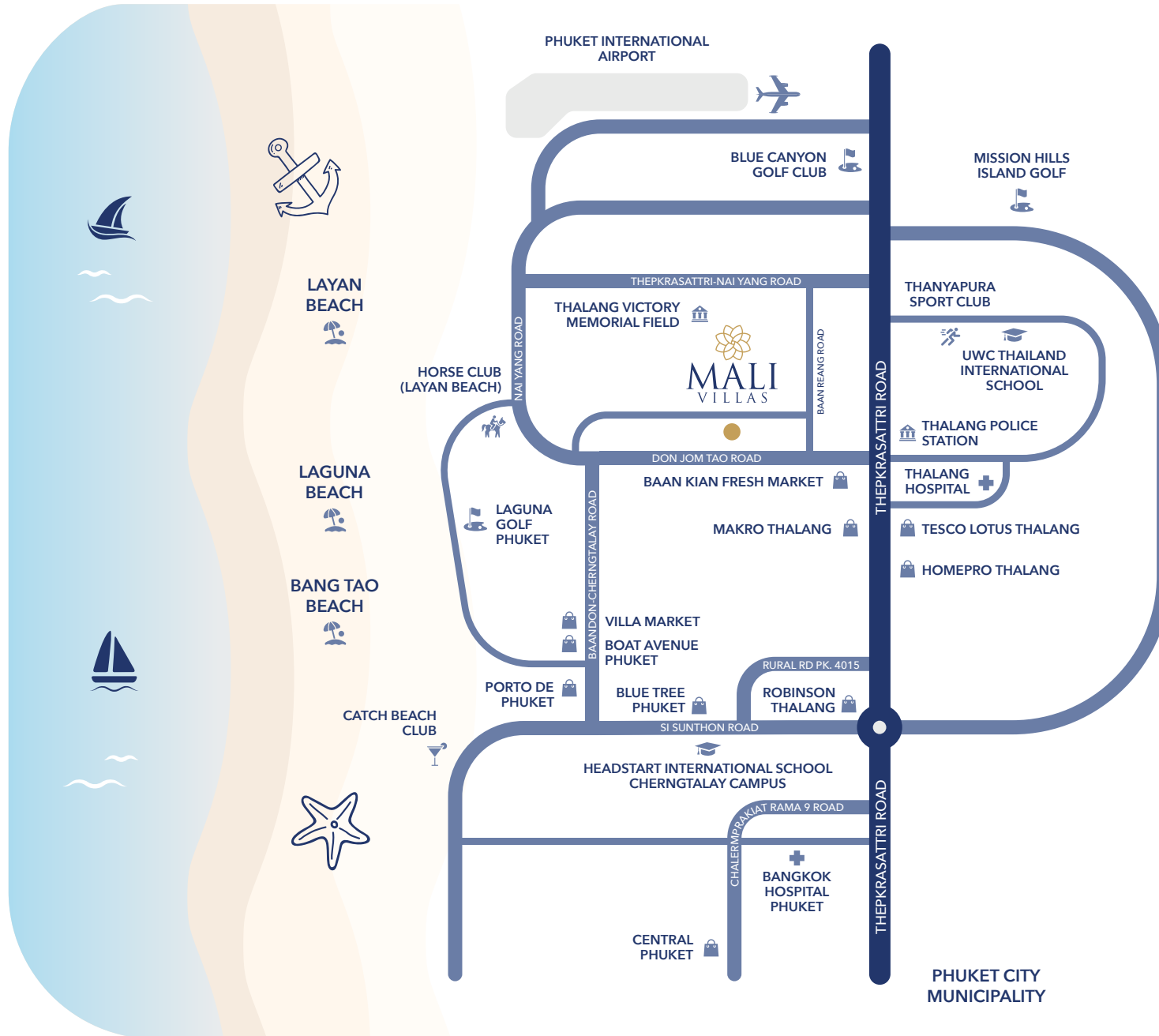
LOCATION

	Lifestyle	
	Tesco Lotus Thalang	1.3 KM.
	Baan Kian Fresh Market	1.5 KM.
	Thalang Victory Memorial Field	2.1 KM.
	HomePro Thalang	2.8 KM.
	Makro Thalang	3.5 KM.
	Villa Market	4.7 KM.
	Boat Avenue Phuket	4.7 KM.
	Porto De Phuket	6.1 KM.
	Blue Tree Phuket	8.0 KM.
	Robinson Thalang	8.1 KM.
	Central Phuket	20.0 KM.
	Entertainment	
	Horse Club (Layan Beach)	3.8 KM.
	Thanyapura Sport Club	6.3 KM.
	Bang Tao Beach	6.5 KM.
	Layan Beach	7.0 KM.
	Catch Beach Club	8.0 KM.
	Laguna Golf Phuket	9.0 KM.
	Blue Canyon Golf Club	13.0 KM.
	Mission Hills Island Golf	14.4 KM.
	Education	
	UWC Thailand International School	6.3 KM.
	HeadStart International School Chergntalay Campus	7.7 KM.
	Hospital	
	Thalang Hospital	3.3 KM.
	Bangkok Hospital Phuket	19.0 KM.
	Transportation	
	Phuket International Airport	12.0 KM.
	Service	
	Thalang Police Station	2.3 KM.



Sales Gallery Location



MALI VILLAS

Exterior Design







MALI VILLAS
Interior Design



LIVING
Room

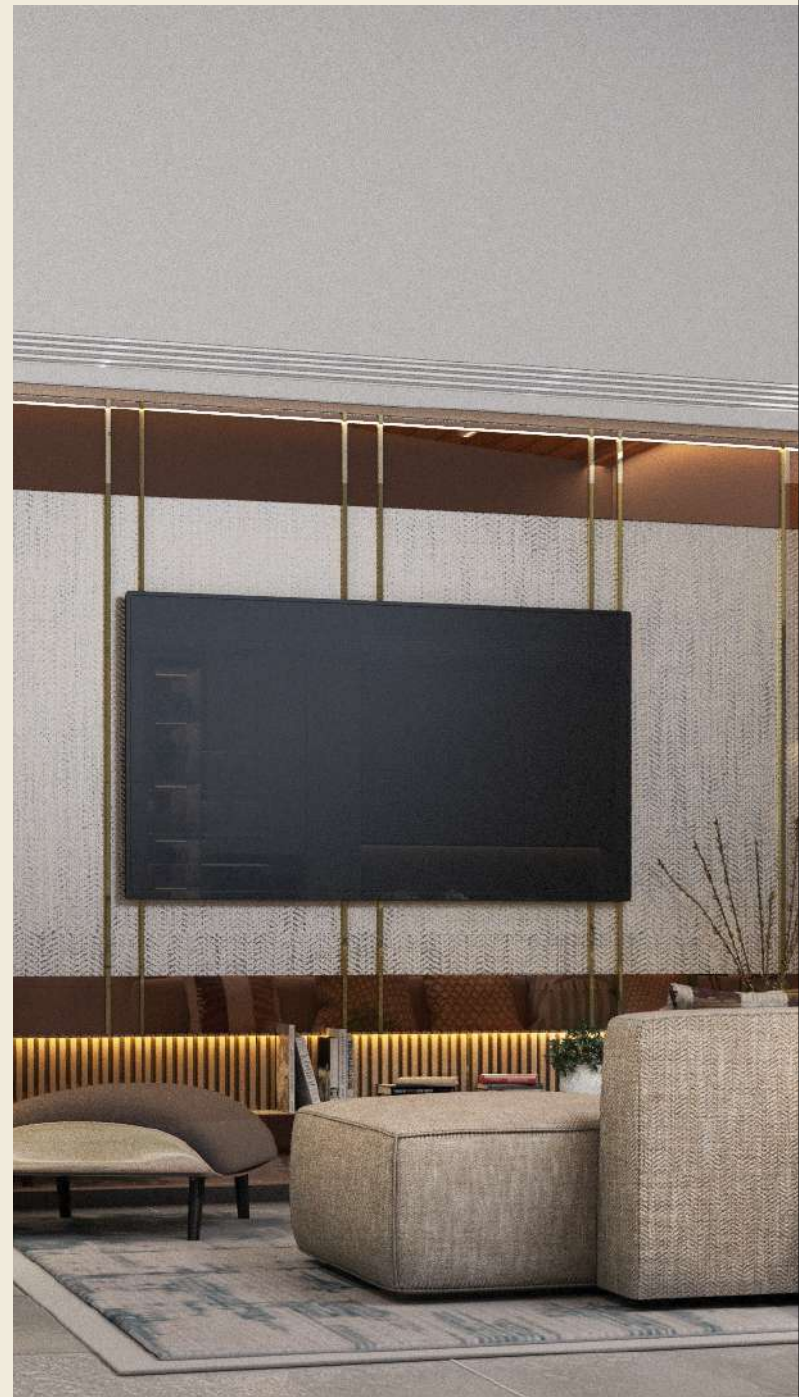



PANTRY



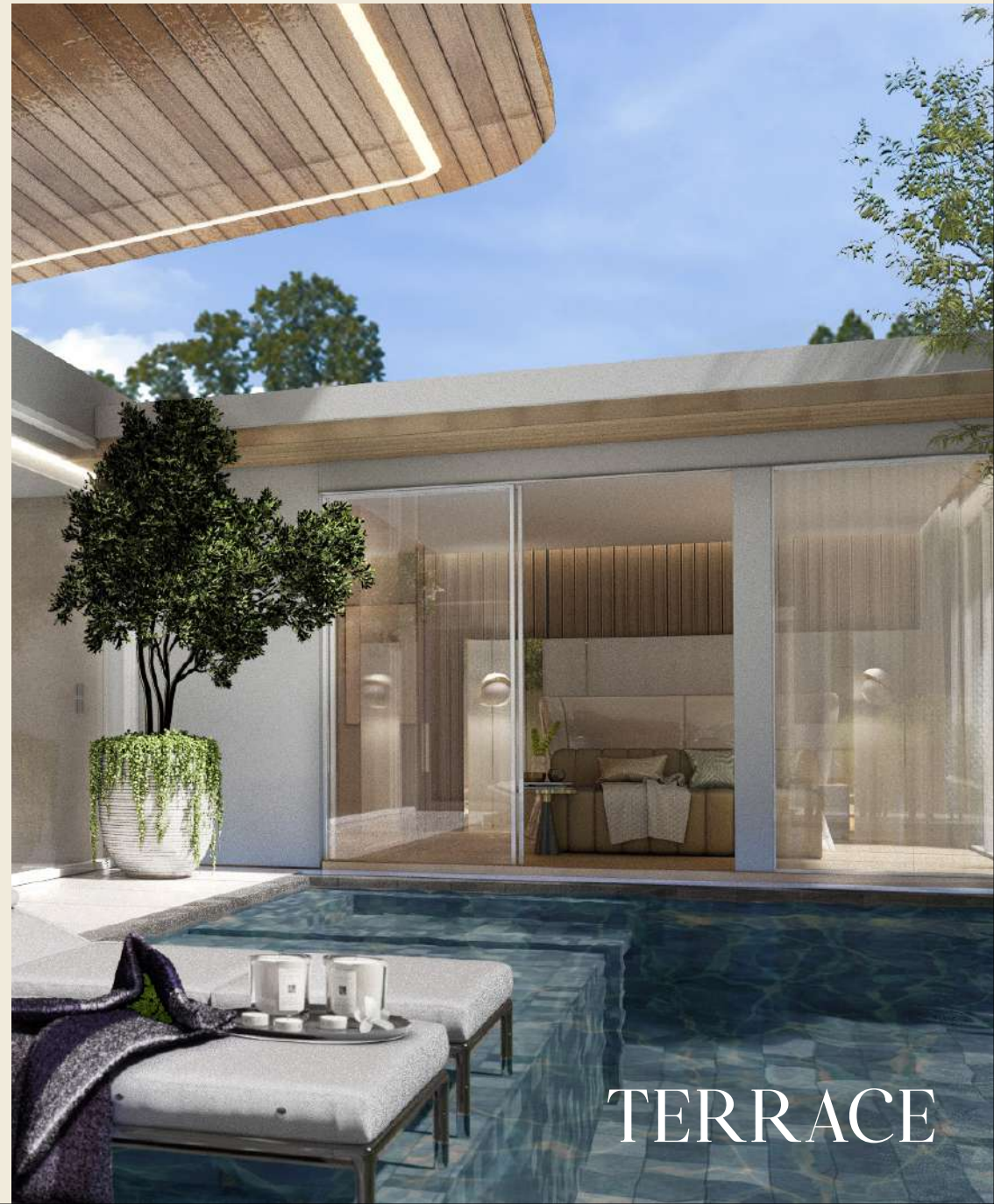

TERRACE

MASTER
Bedroom







BEDROOM 1





BEDROOM 2



MASTER PLAN

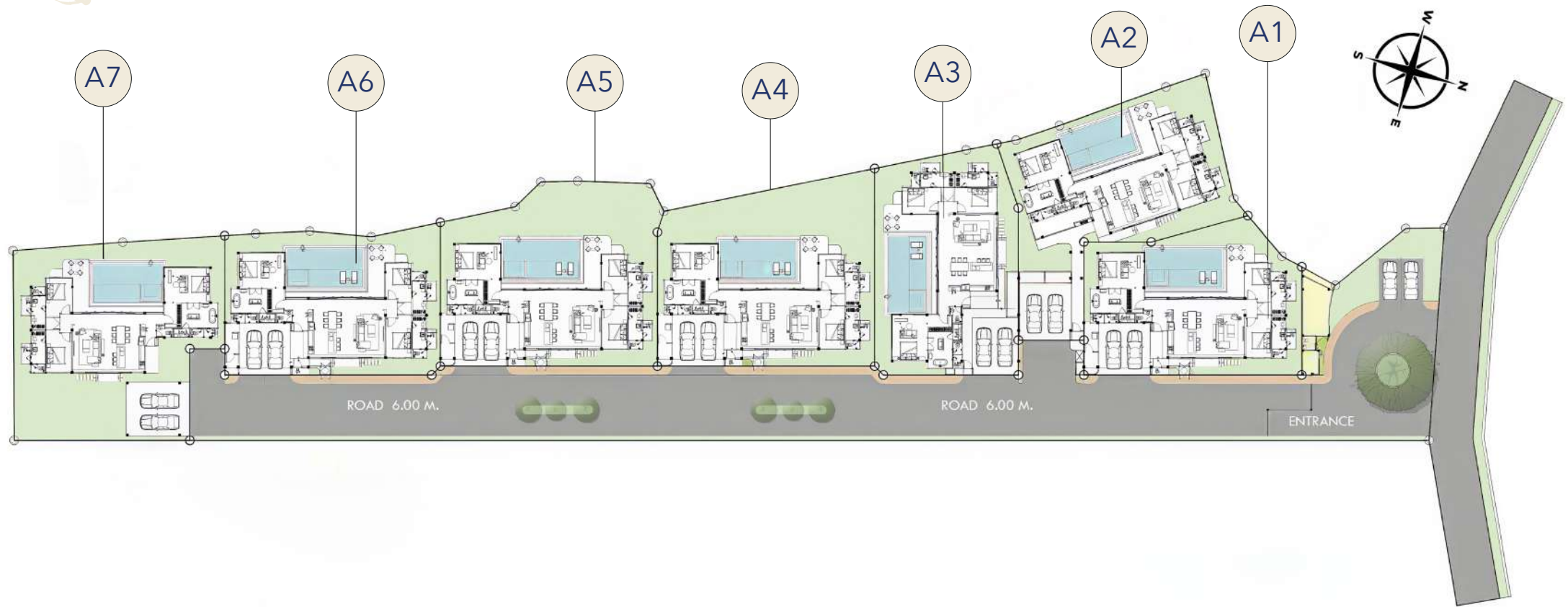

MALIWAN	A1	395.94 SQ.M.
MALICHAT	A2	456.80 SQ.M.
MALILAUNG	A3	407.80 SQ.M.
MALISON	A4	501.40 SQ.M.

MALILA	A5	490.48 SQ.M.
MALULI	A6	404.48 SQ.M.
PHUTTHACHAT	A7	506.72 SQ.M.

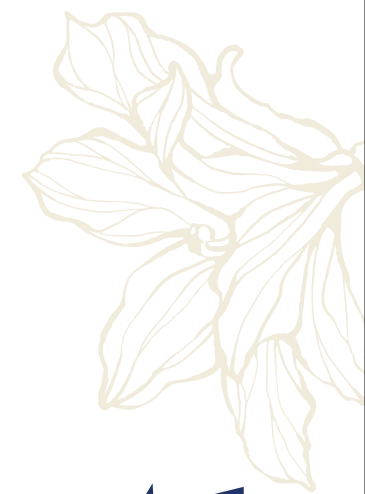

A1 Maliwan



A1 SIZE	395.94 SQ.M.
HOUSE AREA	314.84 SQ.M.
● EXTERNAL AREA	89.83 SQ.M.
● INTERNAL AREA	255.01 SQ.M.
GARDEN AREA	81.10 SQ.M.

3 BEDROOMS (A1)

MASTER BEDROOM
MASTER BATHROOM & WALK IN CLOSET
BEDROOM 2
BATHROOM 2
BEDROOM 3
BATHROOM 3

WC. (POWER RM.)
LIVING ROOM, DINING, PANTRY & FAMILY AREA
CORRIDOR
TERRACE
PARKING FOR 2 CARS
WALK - WAY

SWIMMING POOL (4.70 * 9.00 M.)
POOL TERRACE
LAUNDRY ROOM
STUDY OR WORKING ROOM
GARDEN AREA
PUMP ROOM



A2

Malichat



A2 SIZE	456.80 SQ.M.
HOUSE AREA	332.11 SQ.M.
● EXTERNAL AREA	97.10 SQ.M.
● INTERNAL AREA	233.01 SQ.M.
GARDEN AREA	124.69 SQ.M.

3 BEDROOMS (A2)

MASTER BEDROOM
MASTER BATHROOM & WALK IN CLOSET
BEDROOM 2
BATHROOM 2
BEDROOM 3
BATHROOM 3

WC. (POWER RM.)
LIVING ROOM, DINING, PANTRY & FAMILY AREA
CORRIDOR
TERRACE
PARKING FOR 2 CARS
WALK - WAY

SWIMMING POOL (4.70 * 9.00 M.)
POOL TERRACE
LAUNDRY ROOM
STUDY OR WORKING ROOM
GARDEN AREA
PUMP ROOM

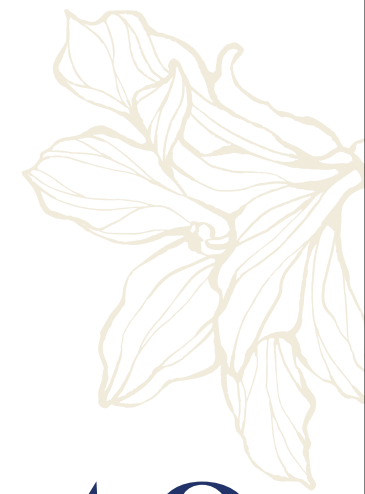

A3 Malilaung



A3 SIZE	407.80 SQ.M.
HOUSE AREA	323.69 SQ.M.
● EXTERNAL AREA	91.18 SQ.M.
● INTERNAL AREA	232.51 SQ.M.
GARDEN AREA	84.11 SQ.M.

3 BEDROOMS (A3)

MASTER BEDROOM
MASTER BATHROOM & WALK IN CLOSET
BEDROOM 2
BATHROOM 2
BEDROOM 3
BATHROOM 3

WC. (POWER RM.)
LIVING ROOM, DINING, PANTRY & FAMILY AREA
CORRIDOR
TERRACE
PARKING FOR 2 CARS
WALK - WAY

SWIMMING POOL (4.70 * 9.00 M.)
POOL TERRACE
LAUNDRY ROOM
STUDY OR WORKING ROOM
GARDEN AREA
PUMP ROOM

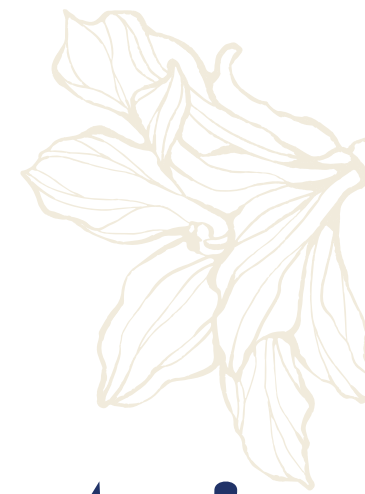

A4 Malison



A4 SIZE	501.40 SQ.M.
HOUSE AREA	314.84 SQ.M.
● EXTERNAL AREA	89.93 SQ.M.
● INTERNAL AREA	225.01 SQ.M.
GARDEN AREA	186.56 SQ.M.

3 BEDROOMS (A4)

MASTER BEDROOM
MASTER BATHROOM & WALK IN CLOSET
BEDROOM 2
BATHROOM 2
BEDROOM 3
BATHROOM 3

WC. (POWER RM.)
LIVING ROOM, DINING, PANTRY & FAMILY AREA
CORRIDOR
TERRACE
PARKING FOR 2 CARS
WALK - WAY

SWIMMING POOL (4.70 * 9.00 M.)
POOL TERRACE
LAUNDRY ROOM
STUDY OR WORKING ROOM
GARDEN AREA
PUMP ROOM



A5 Malila

A5 SIZE	490.88 SQ.M.
HOUSE AREA	314.84 SQ.M.
● EXTERNAL AREA	89.93 SQ.M.
● INTERNAL AREA	225.01 SQ.M.
GARDEN AREA	176.04 SQ.M.

3 BEDROOMS (A5)

MASTER BEDROOM
 MASTER BATHROOM & WALK IN CLOSET
 BEDROOM 2
 BATHROOM 2
 BEDROOM 3
 BATHROOM 3

WC. (POWER RM.)
 LIVING ROOM, DINING, PANTRY & FAMILY AREA
 CORRIDOR
 TERRACE
 PARKING FOR 2 CARS
 WALK - WAY

SWIMMING POOL (4.70 * 9.00 M.)
 POOL TERRACE
 LAUNDRY ROOM
 STUDY OR WORKING ROOM
 GARDEN AREA
 PUMP ROOM

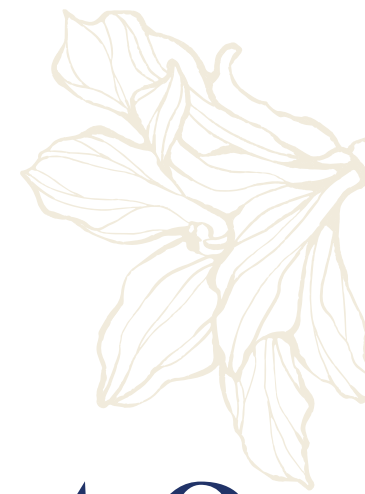

A6 Maluli



A6 SIZE	404.48 SQ.M.
HOUSE AREA	314.84 SQ.M.
● EXTERNAL AREA	89.93 SQ.M.
● INTERNAL AREA	225.01 SQ.M.
GARDEN AREA	89.64 SQ.M.

3 BEDROOMS (A6)

MASTER BEDROOM

MASTER BATHROOM & WALK IN CLOSET

BEDROOM 2

BATHROOM 2

BEDROOM 3

BATHROOM 3

WC. (POWER RM.)

LIVING ROOM, DINING, PANTRY & FAMILY AREA

CORRIDOR

TERRACE

PARKING FOR 2 CARS

WALK - WAY

SWIMMING POOL (4.70 * 9.00 M.)

POOL TERRACE

LAUNDRY ROOM

STUDY OR WORKING ROOM

GARDEN AREA

PUMP ROOM

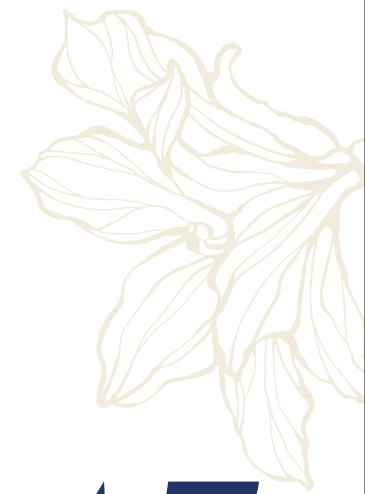

A7

Phutthachat

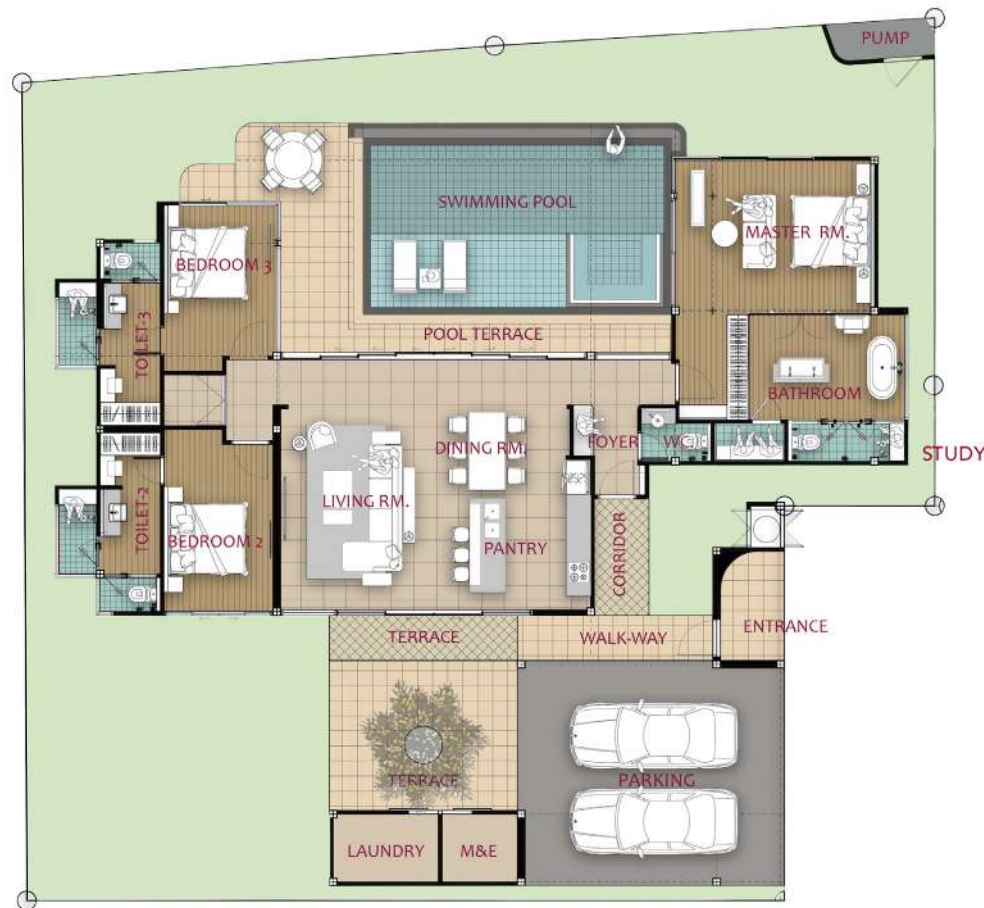

A7 SIZE	506.72 SQ.M.
HOUSE AREA	342.86 SQ.M.
● EXTERNAL AREA	110.35 SQ.M.
● INTERNAL AREA	232.51 SQ.M.
GARDEN AREA	163.86 SQ.M.

3 BEDROOMS (A7)

MASTER BEDROOM

MASTER BATHROOM & WALK IN CLOSET

BEDROOM 2

BATHROOM 2

BEDROOM 3

BATHROOM 3

WC. (POWER RM.)

LIVING ROOM, DINING, PANTRY & FAMILY AREA

CORRIDOR

TERRACE

PARKING FOR 2 CARS

WALK - WAY

SWIMMING POOL (4.70 * 9.00 M.)

POOL TERRACE

LAUNDRY ROOM

STUDY OR WORKING ROOM

GARDEN AREA

PUMP ROOM



Project *Highlight*

7

EXQUISITE VILLAS

Each a sanctuary of
exclusivity and elegance.



Nestled near Phuket's renowned
beaches and lifestyle community.



Located only 30 minutes from
Phuket International Airport





A serene enclave of private residences,
where luxury and tranquility intertwine.



Conveniently situated near
commercial shopping destinations.



 www.malivillas.com

 +66 62 429 5564



PLUS+
SOLE AGENT